

## AXIS M30-VE Network Cameras

Outdoor-ready, day/night fixed mini domes with HDTV performance.



- > Compact, vandal-resistant, outdoor-ready design
- > HDTV/multi-megapixel video
- > Day/night functionality
- > Built-in IR illumination
- > Easy to install with Power over Ethernet and edge storage
- > Input/output ports for external devices

AXIS M30-VE Network Cameras, which are part of the AXIS M30 Series, are affordably priced, vandal-resistant HDTV fixed mini domes for excellent video during day and night-time conditions in indoor or outdoor environments. They are ideal for installation inside or outside the entrance of a hotel, boutique, restaurant, office or school.

AXIS M3024-LVE provides 1-megapixel and HDTV 720p video and offers built-in IR illumination for surveillance even in complete darkness. AXIS M3025-VE supports 2-megapixel resolution in full HDTV 1080p. AXIS M3026-VE is a wide-angle, light-sensitive 3-megapixel/HDTV 1080p camera that can also stream different view areas within its field of view.

AXIS M30-VE cameras are outdoor-ready and impact resistant, with IP66, NEMA 4X and IK10 ratings. The fixed domes can be mounted on walls, ceilings or pendants. They have a 3-axis camera angle adjustment for flexible installation. They also support Axis' Corridor Format for vertically oriented video streams that maximize coverage of areas such as along walls or aisles. The cameras come focused at delivery.

AXIS M30-VE cameras have input/output ports for connection to external devices. The cameras also support AXIS Camera Application Platform for intelligent video applications. AXIS M3026-VE has substantial capacity for video analytics.

The fixed domes offer a convenient video management solution with their built-in memory card slot for edge storage and support for software such as the complimentary AXIS Camera Companion.

The cameras come with a 2 m (6.6 ft.) network cable and are powered using Power over Ethernet (IEEE 802.3af).



## Day/night functionality and IR illumination

The day/night functionality in AXIS M30-VE cameras is useful for surveillance in indoor or outdoor environments with changing lighting conditions. The day/night functionality involves an automatically removable infrared-cut filter in the cameras. The filter is on during daytime or bright conditions, enabling the cameras to produce colors as the human eye sees them. In nighttime or low-light conditions, the filter is removed to enable the cameras to take advantage of invisible near-infrared light

from available light sources to produce good quality black and white images. The functionality allows the cameras to extend their usefulness in low-light conditions and enables IR (infrared) illuminators to be used to further improve video quality in dark environments. AXIS M3024-LVE has built-in IR illuminators and is ideal for surveillance in complete darkness. AXIS M3024-LVE uses high-efficiency, long-life 850 nm IR LEDs.



The above images from AXIS M3025-VE illustrate the camera's day/night functionality: at left, day mode; at right, night mode.

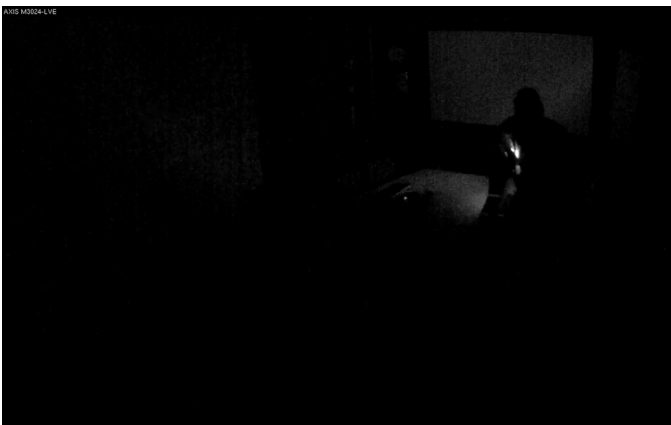

The above images from AXIS M3024-LVE—depicting the same scenario of a man with a small flashlight in a dark room—show the difference that IR illumination makes for surveillance in the dark. The image at left is without the use of IR illuminators. The image at right uses IR light from the camera's built-in IR LEDs. IR light is invisible to the human eye but visible to the camera.

## Schematic for a small surveillance system

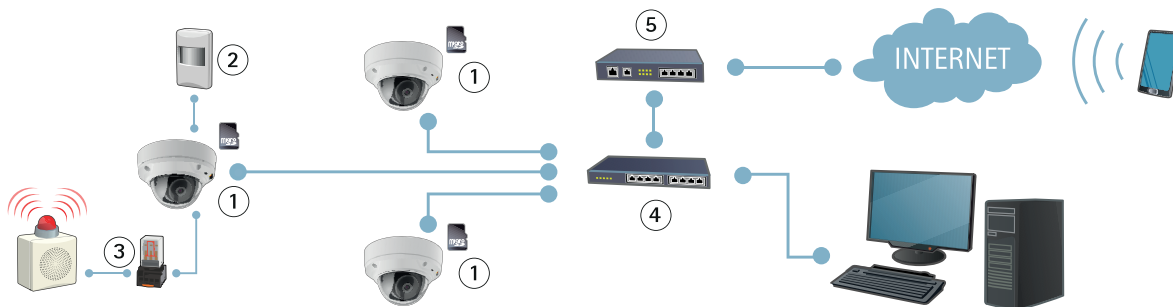

The illustration above shows a system that uses AXIS M30-VE cameras together with AXIS Camera Companion (1) for video management; input and output ports to external equipment such as a PIR detector (2) and alarm (3) for enhanced alarm management; PoE switch (4) for local networking and Power over Ethernet; and router (5) for Internet access.

## Under the cover



Camera parts: 1) attached 2 m (6.6 ft.) network cable; 2) memory card slot; 3) one input and one output port; 4) built-in IR illuminators (AXIS M3024-LVE only)

## Dimensions

AXIS M3024-LVE  
AXIS M3025-VE  
AXIS M3026-VE

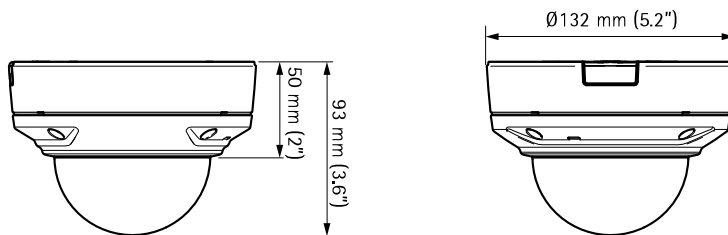

## Optional accessories

### For indoor use:

1. AXIS T94F01D Pendant Kit with Network Cable Coupler Indoor
2. AXIS T94F01L Recessed Mount Kit with Network Cable Coupler Indoor

### For outdoor use:

3. Network Cable Coupler IP66 (can fit inside AXIS T94F02D Pendant Kit)
4. AXIS T94F02D Pendant Kit with sunshield

### For indoor or outdoor use:

5. AXIS T94F01M J-Box/Gang Box Plate and Network Cable Coupler Indoor (coupler must be placed in waterproof area)
6. AXIS T91 Mounting Accessories

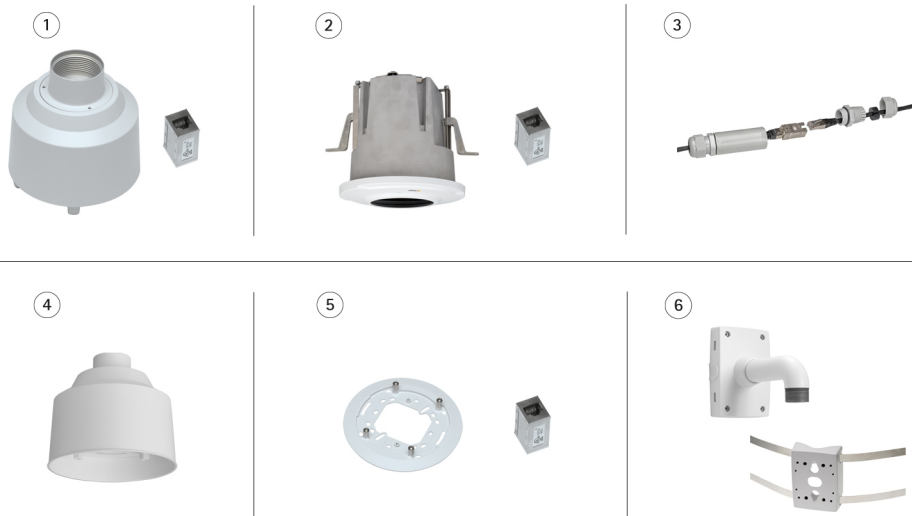

## Technical Specifications – AXIS M30-VE Network Cameras

<b>Models</b>	AXIS M3024-LVE: 1 MP / HDTV 720p, IR illumination AXIS M3025-VE: 2 MP / HDTV 1080p AXIS M3026-VE: 3 MP / HDTV 1080p
<b>Camera</b>	
<b>Image sensor</b>	AXIS M3024-LVE: 1/4" progressive scan RGB CMOS AXIS M3025-VE: 1/2.7" progressive scan RGB CMOS AXIS M3026-VE: 1/3.6" (effective) progressive scan RGB CMOS
<b>Lens</b>	M12 mount, fixed iris, megapixel resolution, IR corrected AXIS M3024-LVE: 2.8 mm, 77° view <sup>a</sup> , F2.0 AXIS M3025-VE: 3.6 mm, 91° view <sup>a</sup> , F2.0 AXIS M3026-VE: 2.0 mm, 106° view <sup>a</sup> , F2.0
<b>Day and night</b>	Automatically removable infrared-cut filter
<b>Light sensitivity/minimum illumination</b>	AXIS M3024-LVE: Color: 0.8–100000 lux, F2.0 B/W: 0.16 lux, F2.0, 0 lux with IR illumination on AXIS M3025-VE: Color: 0.8–100000 lux, F2.0 B/W: 0.16 lux, F2.0 AXIS M3026-VE: Color: 0.3–200000 lux, F2.0 B/W: 0.06 lux, F2.0
<b>Shutter time</b>	AXIS M3024-LVE/M3025-VE: 1/8000 s to 1/6 s AXIS M3026-VE: 1/30500 s to 2 s
<b>Camera angle adjustment</b>	AXIS M3024-LVE: Pan ±175°, tilt 65°, rotation ±175° AXIS M3025-VE/M3026-VE: Pan ±175°, tilt 70°, rotation ±175° <sup>a</sup>
<b>Video</b>	
<b>Video compression</b>	H.264 Main Profile (MPEG-4 Part 10/AVC) Motion JPEG AXIS M3026-VE: Also H.264 Baseline Profile
<b>Resolutions</b>	AXIS M3024-LVE: 1280x800 (1 MP) to 320x240 AXIS M3025-VE: 1920x1080 (2 MP/HDTV 1080p) to 320x240 AXIS M3026-VE: 2048x1536 (3 MP) to 160x120
<b>Frame rate</b>	AXIS M3024-LVE/M3025-VE: 25/30 fps with power line frequency 50/60 Hz AXIS M3026-VE: 3 MP capture mode: 16/20 fps with power line frequency 50/60 Hz; HDTV 1080p (1920x1080) and 2 MP 4:3 (1600x1200) capture modes: 25/30 fps with power line frequency 50/60 Hz
<b>Video streaming</b>	Multiple, individually configurable streams in H.264 and Motion JPEG Controllable frame rate and bandwidth VBR/CBR H.264
<b>Pan/Tilt/Zoom</b>	Digital PTZ AXIS M3026-VE: Preset positions, guard tour
<b>Multi-view streaming</b>	AXIS M3026-VE: Up to 8 individually cropped out view areas. When streaming 4 view areas and 1 overview in VGA resolution, the frame rate is 16/20 fps per stream with power line frequency 50/60 Hz (3 MP capture mode)
<b>Image settings</b>	Compression, Color, Brightness, Sharpness, Contrast, White balance, Exposure control, Backlight compensation, Wide dynamic range – dynamic contrast Rotation: 0°, 90°, 180°, 270°, including Corridor Format Text and image overlay, Mirroring of images, Privacy mask AXIS M3026-VE: Exposure zones, Fine tuning of low light behavior
<b>Network</b>	
<b>Security</b>	Password protection, IP address filtering, HTTPS <sup>b</sup> encryption, IEEE 802.1X <sup>b</sup> network access control, Digest authentication, User access log
<b>Supported protocols</b>	IPv4/v6, HTTP, HTTPS <sup>b</sup> , SSL/TLS <sup>b</sup> , QoS Layer 3 DiffServ, FTP, CIFS/SMB, SMTP, Bonjour, UPnP, SNMPv1/v2c/v3 (MIB-II), DNS, DynDNS, NTP, RTSP, RTP, TCP, UDP, IGMP, RTCP, ICMP, DHCP, ARP, SOCKS
<b>System integration</b>	
<b>Application Programming Interface</b>	Open API for software integration, including VAPIX <sup>®</sup> and AXIS Camera Application Platform; specifications at <a href="http://www.axis.com">www.axis.com</a> AXIS Video Hosting System (AVHS) with One-Click Camera Connection ONVIF Profile S; specification at <a href="http://www.onvif.org">www.onvif.org</a>
<b>Intelligent video</b>	Video motion detection, Active tampering alarm, AXIS Camera Application Platform enabling installation of additional applications
<b>Event triggers</b>	Intelligent video, Edge storage events, External input
<b>Event actions</b>	File upload: FTP, HTTP, network share and email Notification: email, HTTP and TCP External output activation Video recording to edge storage Pre- and post-alarm video buffering AXIS M3026-VE: Go to PTZ preset, guard tour
<b>Data streaming</b>	Event data
<b>Built-in installation aids</b>	Pixel counter
<b>General</b>	
<b>Casing</b>	IP66- and NEMA 4X-rated, IK10 impact-resistant aluminum casing with transparent, polycarbonate cover and dehumidifying membrane Encapsulated electronics Captive screws (resistor 10) Color: white NCS S 1002-B
<b>Memory</b>	AXIS M3024-LVE/M3025-VE: 256 MB RAM, 128 MB Flash AXIS M3026-VE: 512 MB RAM, 128 MB Flash
<b>Power</b>	Power over Ethernet IEEE 802.3af/802.3at Type 1 AXIS M3024-LVE: Class 2, max. 3.4 W AXIS M3025-VE: Class 2, max. 3.2 W AXIS M3026-VE: Class 2, max. 4.5 W
<b>IR illumination</b>	AXIS M3024-LVE: High-efficiency, long-life 850 nm IR LEDs; range of reach up to 10 m (33 ft.) depending on scene
<b>Connectors</b>	Male RJ45 10BASE-T/100BASE-TX PoE on a 2 m (6.6 ft.) network cable; warranty can be maintained even when cable is cut—for more information, contact your Axis partner Terminal block for 1 alarm input and 1 output
<b>Edge storage</b>	MicroSD/microSDHC/microSDXC slot supporting memory card up to 64 GB (card not included); support for recording to network share (network-attached storage or file server)
<b>Operating conditions</b>	-30 °C to 50 °C (-22 °F to 122 °F) Humidity 10–100% RH (non-condensing)
<b>Approvals</b>	EN 55022 Class B, EN 55024, EN 61000-6-1, EN 61000-6-2, FCC Part 15 Subpart B Class B, ICES-003 Class B, VCCI Class B, AS/NZS CISPR 22 Class B, KCC KN22 Class B, KN24, IEC/EN/UL 60950-22, EN 50581, IEC 60529 IP66, NEMA 250 Type 4X, IEC 62262 IK10 AXIS M3024-LVE: IEC 62471
<b>Weight</b>	AXIS M3024-LVE: 770 g (1.7 lb.) AXIS M3025-VE/M3026-VE: 740 g (1.6 lb.)
<b>Included accessories</b>	Drill hole template, Resistor L-key, Terminal block connector, Installation Guide, Installation and Management Software CD, Windows decoder 1-user license
<b>Video management software</b>	AXIS Camera Companion (included), AXIS Camera Station and video management software from Axis' Application Development Partners (not included). See <a href="http://www.axis.com/products/video/software">www.axis.com/products/video/software</a>
<b>Warranty</b>	Axis 1-year warranty and AXIS Extended Warranty option, see <a href="http://www.axis.com/warranty">www.axis.com/warranty</a>

- a. Horizontal angle of view  
b. This product includes software developed by the OpenSSL Project for use in the OpenSSL Toolkit (<http://www.openssl.org/>), and cryptographic software written by Eric Young ([ey@cryptsoft.com](mailto:ey@cryptsoft.com)).

More information is available at [www.axis.com](http://www.axis.com)